



KIM TIN GROUP PORTFOLIO

WELDING CONSUMABLES



Table of Contents

Portfolio
2024

KIM TIN GROUP PROFILE

1

3	Vision - Mission - Core Values
4-6	Kim Tin's business story
7	Achievement - Awards
8	Production capacity
10	Long An production plant
11	Hung Yen production plant
12	Kim Tin Group's business segments
15	Quality standard

2

WELDING CONSUMABLES

17	Welding electrodes
18	Welding wires

3

KIM TIN GROUP STRATEGY

25	Our strategy
----	--------------

4

DISTRIBUTION

27	Distribution network
----	----------------------



**KIM TIN'S
BUSINESS STORY**

Mission - Vision Core Values

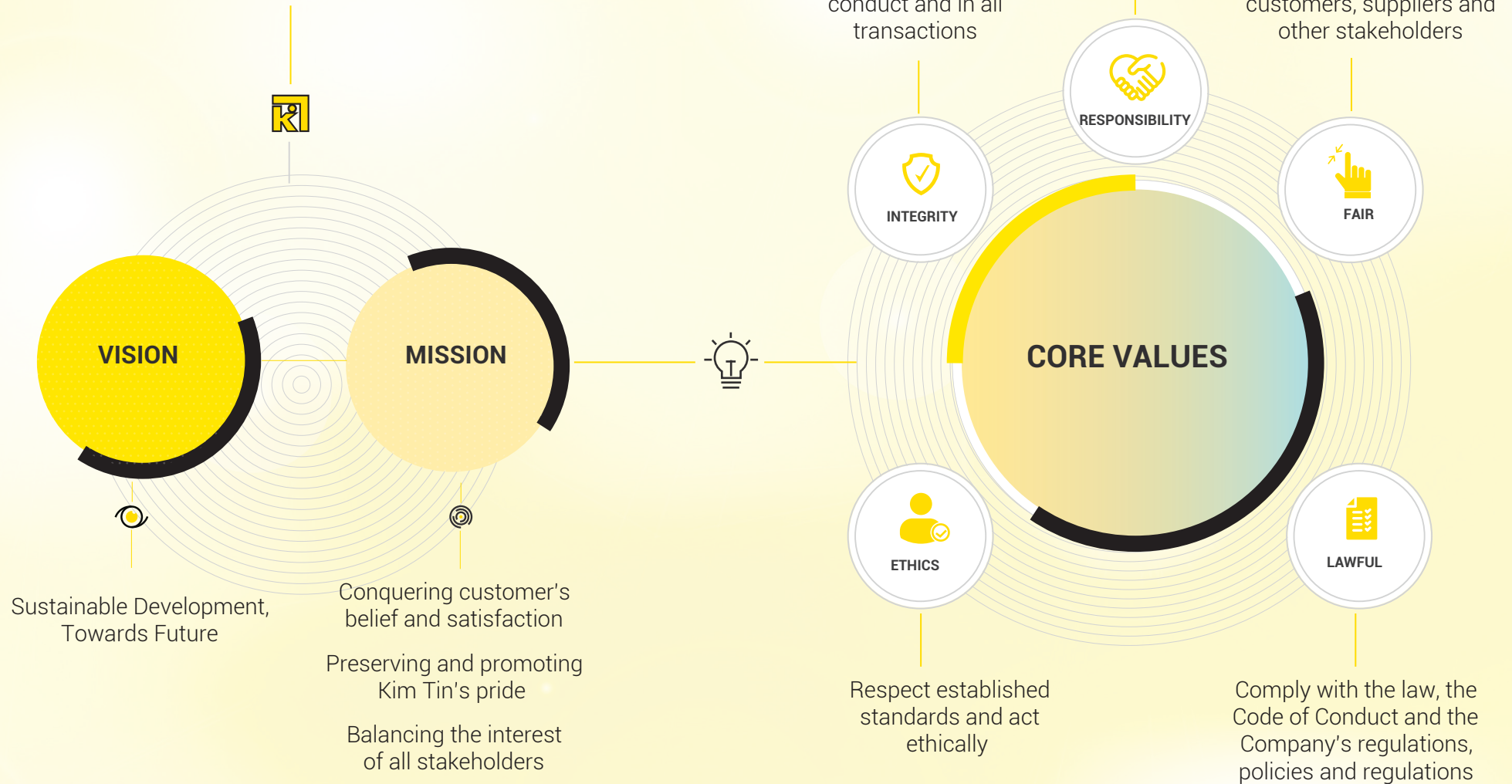

■ About Kim Tin Group



Kim Tin's Story

“

For more than 24 years of establishment and development, Kim Tin has always persistently pursued the path of sustainable development, with a focus on balancing the interests of all stakeholders. At the same time, we thrive to maintain the promise of our commitment to providing the best product quality and service quality to our customers.



■ About Kim Tin Group



Kim Tin's Story



2010

2010

Establish Kim Tin Quang Tri with capacity of 48 tons/ year, total area of 45.000 m².

2015

Kim Tin promoted the development and expansion of Logistics services, established nPL Logistics Joint Stock Company with more than 100 container trucks.

Expanded Hung Yen welding material factory, bringing the total capacity of Hung Yen factory to 68.000 tons/year, with an area of 70.000 m².

“

For more than 24 years of establishment and development, Kim Tin has always persistently pursued the path of sustainable development, with a focus on balancing the interests of all stakeholders. At the same time, we thrive to maintain the promise of our commitment to providing the best product quality and service quality to our customers.

2021

2021

Became the first private company to deploy the comprehensive management system SAP S/4HANA; S&OP; MES with total investment of 5 million USD.

■ About Kim Tin Group



Kim Tin's Story



2022

2022

Launching Kim Tin Decor for printing and impregnated paper to fulfill value chain of wood and value-added wood products.

Kim Tin Group owns 6 manufacturing factories with an area of 1.200.000 m², with production capacity of up to 1.000.000 m³ of MDF/HDF, 40.000.000 m² of printing - impregnated - melamine boards each year.

“

For more than 24 years of establishment and development, Kim Tin has always persistently pursued the path of sustainable development, with a focus on balancing the interests of all stakeholders. At the same time, we thrive to maintain the promise of our commitment to providing the best product quality and service quality to our customers.

2023

2023

Launching KES brand for

Continue to research and
develop our products

Digitalization
evolution

Achievement Awards

Always focusing on customers, Kim Tin constantly improves the quality of products and services through research and development, building ERP systems. Therefore, Kim Tin is increasingly trusted by customers.



(2010 - 2023)
TOP 500 BIGGEST COMPANY
IN VIETNAM
VNR500

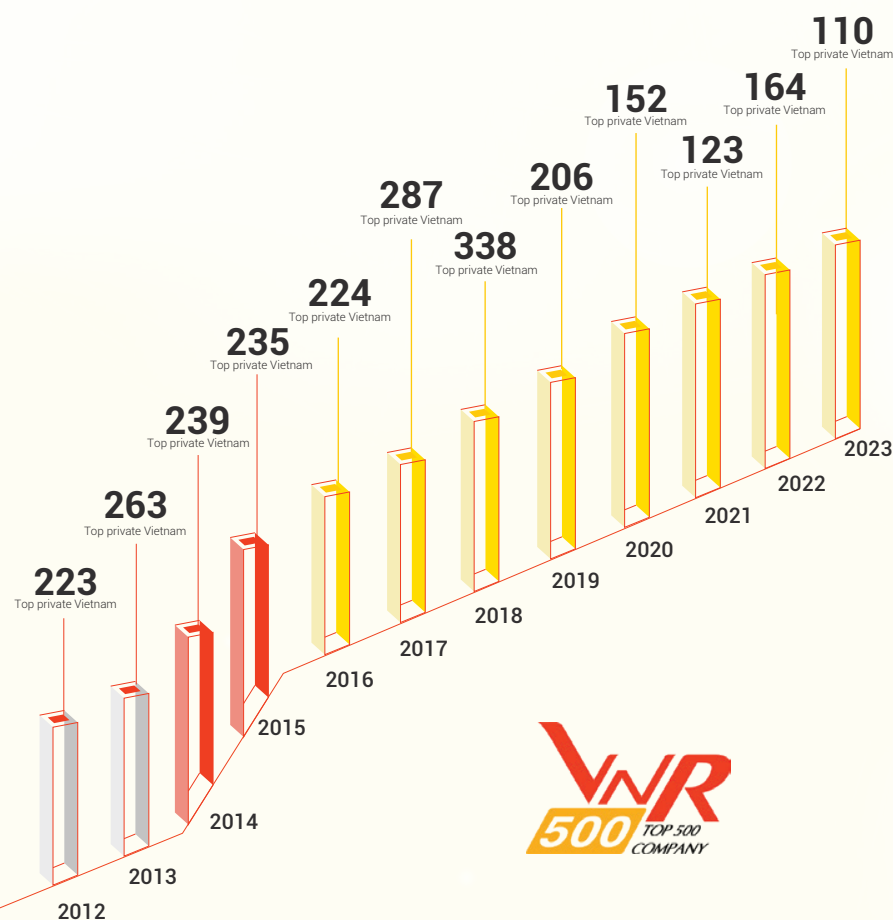

Top **100**
Sustainable Business



The award of National Brand
in Vietnam



Rank **151**
in the top 500



TOP 10
business at the Asia Economic
and Integration Forum



TOP 10
brand in Vietnam organized
by Vietnam Union of Science
and Business Development
and Dat Viet Communica-
tion and Consulting Joint
Stock Company



Rank **33**
in the top 500 fastest
developed company in
Vietnam



PRODUCTION CAPACITY



Production Capacity



From a company that imported and distributed welding electrodes, Kim Tin confidently built our first welding electrode factory with production capacity of 20.000 tons/ year. Currently, we have two factories manufacturing welding consumables in Long An and Hung Yen.



230.000

TONS/YEAR



With 45% market share
in Vietnam

45%



Exporting

28.000

Tons/year

2

BIGGEST WELDING
CONSUMABLES
FACTORIES IN
VIETNAM

ABS **TuV**
NK **DNV** **JIS**
CE

Factory in Long An

Plant area:

120.000m²

Capacity:

120.000tons/year

Product portfolio:

Welding Wire, Welding Electrodes, Steel Nail



Factory in Hung Yen

Plant area:

70.000m²

Capacity:

110.000tons/year

Product portfolio:

Welding Wire, Welding Electrodes



BUSINESS SEGMENTS



■ Business Segments



This is an illustration of Kim Tin Group's business segments, not the corporate legal structure



	WELDING CONSUMABLES	WOOD INDUSTRY	INDUSTRIAL PROPERTIES AND LOGISTICS FOR LEASE	RENEWABLE ENERGY INDUSTRY	HOTELS & RESORTS
REVENUE (2021)	270 USD mil	98 USD mil	n.a (under restructuring)	3 USD mil	5 USD mil
PRODUCTION FACILITY	<p>Hung Yen factory: 110.000 tons/year</p> <p>Long An factory: 120.000 tons/year</p> <p>Titanium factory (Quang Tri): 48.000 tons/year</p>	<p>MDF1: 100.000 m³/year</p> <p>MDF2: 400.000 m³/year</p> <p>MDF3 (2023): 480.000 m³/year</p> <p>MDF4 (2024): 480.000 m³/year</p>	<p>Total land bank: 220ha (Quang Ngai, Dong Nai, Binh Phuoc, Thai Nguyen, Bac Ninh, v.v.)</p> <p>Developed land bank for Kim Tin's factories: ~65ha</p> <p>Developed warehouse for lease ~40ha.</p> <p>Available land bank ~115ha</p>	<p>Rooftop solar: Total current capacity ~40MW</p> <p>Planned future rooftop solar capacity >160MW</p>	<p>Sala Danang Beach Hotel</p> <p>Sala Tuyhoa Beach Hotel</p> <p>Sala Grand Tuyhoa Hotel</p>

■ Quality standards

Kim Tin constantly researches and improves product quality to meet the increasingly demanding needs of customers.

**ALL PRODUCTS KIM TIN
PRODUCED ARE SUCCESSFUL
INTERNATIONAL STANDARDS**

**BVQI
NK
ABS^{DNV}
JIS
TuV
CE**



ClassNK



WELDING CONSUMABLES



Welding Electrodes



Welding Electrode E6013 - KT-421

Mild steel electrodes E6013 and KT-421 is a low carbon welding rod suitable for welding Carbon steel and low alloy steel with medium load structures such as industrial factory structures, machine parts, railings, iron doors....



Mild steel electrodes with high tensile strength: GL-52

Mild steel electrodes GL-52 welds low-carbon and low-alloy steels, with tensile strength $\geq 510\text{N/mm}^2$. GL-52 is the best choice for welded structural strength problems, suitable for ship structures, construction, wharfs, heavy-duty beams, pressure tanks, etc



Stainless steel electrodes G-308

Stainless steel electrodes G-308 is suitable for welding austenitic stainless steel (stainless steel) such as E304; E305, E308.. sometimes with good mechanical properties, high strength and toughness, G-308 is also used in structures subject to heavy loads and high wear resistance.

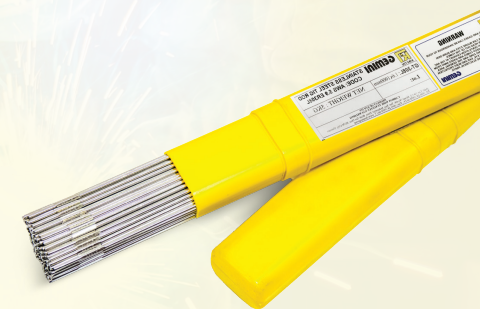

TIG welding electrode ER308L

TIG welding electrode ER308L is suitable for welding all kinds of tanks, chemical tanks, load-bearing structures, acid-resistant, equipment in the medical and food industries... ER70S is suitable for bottom sealing such as pressure tanks, pipelines, etc. load-bearing steel structures, civil structures, cars, ships...

Welding Wires



MIG/MAG Welding wire ER70S-6

ER70S-6 is mainly used in companies that manufacture car components, motorcycles, precision mechanical manufacturing, etc., where welding is done by pre-programmed robots



SAW Welding Wire EL-12

The advantage of automatic and semi-automatic welding under the fluxed layer of Gemini EL-12 welding wire is to ensure the quality of the good weld - uniform, high productivity and save welding wire.



SAW Welding Wire EM-12K

The basic advantage of automatic and semi-automatic welding under the drug layer of Gemini EM - 12K welding wire is to ensure the quality of the good weld - uniform, high productivity and save welding wire



Stainless Steel Welding Wire GM-308L

GM-308L is welded by semi-automatic technology with 100% Argon shielding gas (MIG welding) to create a stable weld with little splash, bright smooth weld. GM-308 is suitable for welding chemical tanks, load-bearing structures, acid-resistant as well as medical equipment

PACKAGE

KT-6013 - 5KG



KT-6013 - 1KG



KT-6013 - 100PCS



PACKAGE

GM - 70S

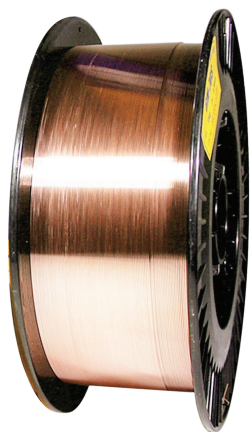

D100

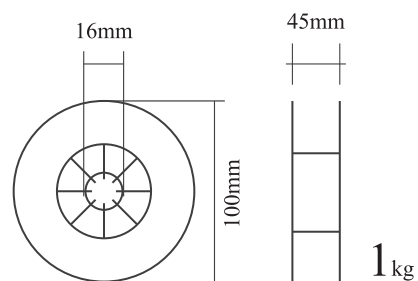

D250

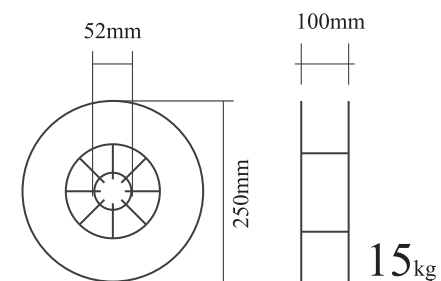

D200

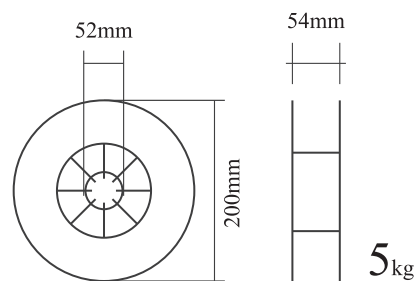

D270

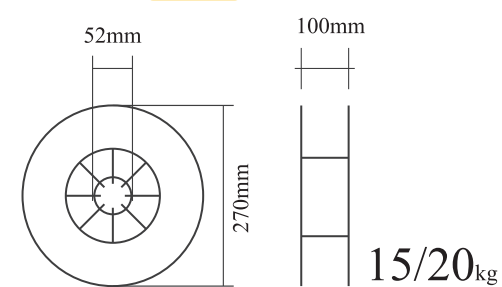

BS300

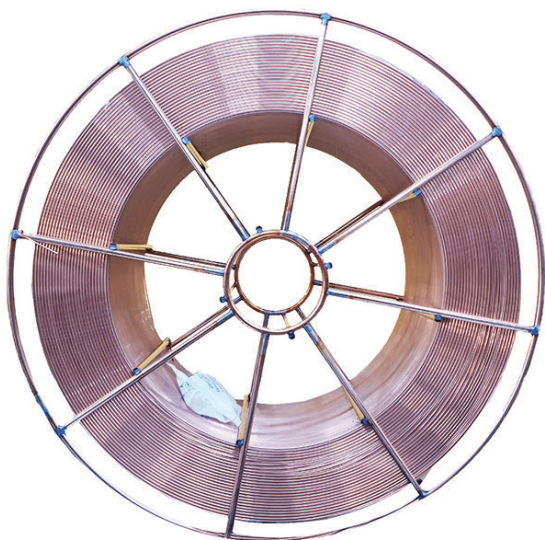

D300

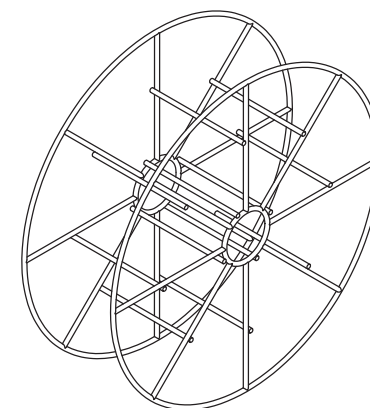
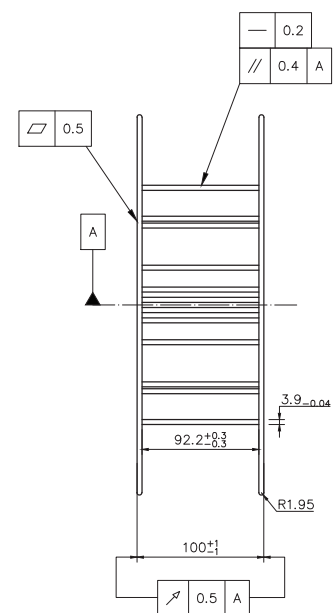
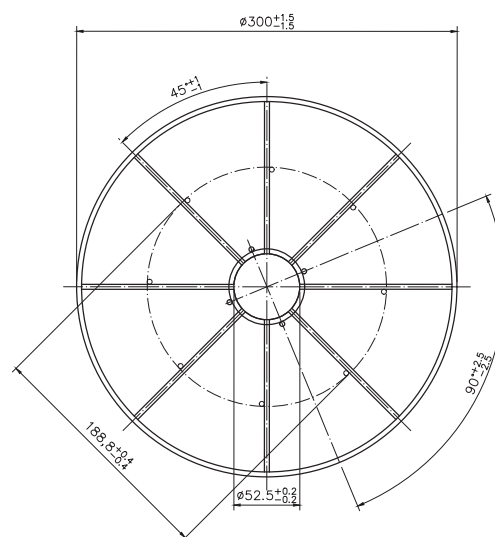

GM - 308L



D100

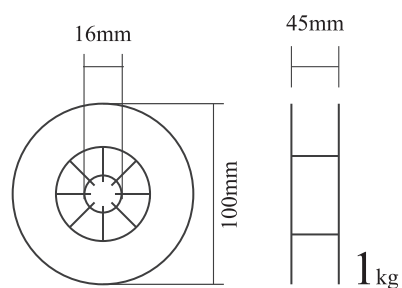

D200

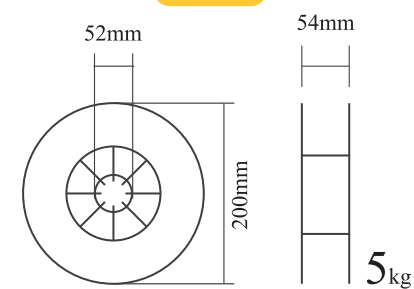

D270

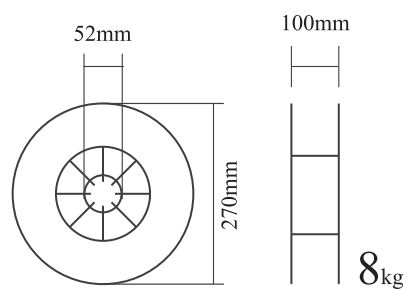

KF- 71T

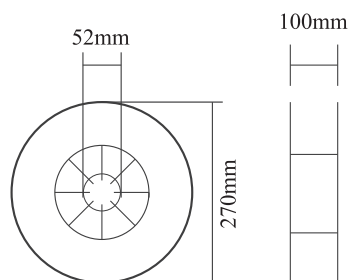

EM - 12K

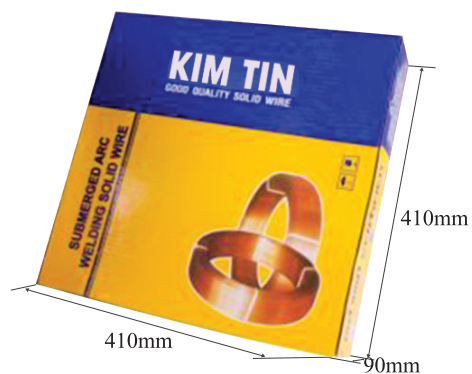

EL - 12

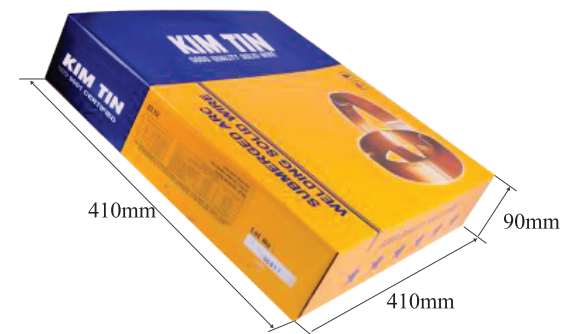

EL - 12

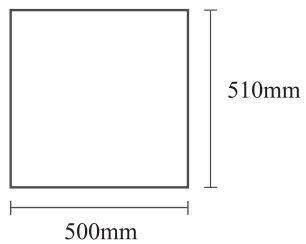

125kg

EM - 12K

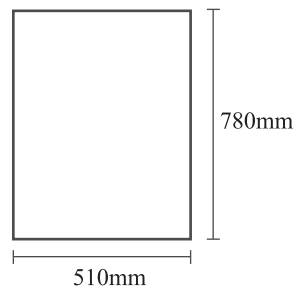

250/300kg

GM - 70S

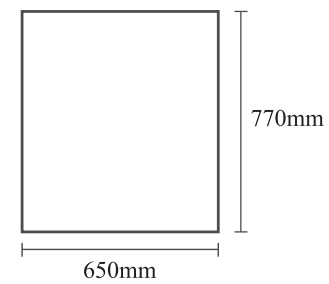

350kg

A black and white photograph of a welder wearing a full protective suit and a large, clear face shield. The welder is wearing heavy-duty gloves and is focused on welding a metal component. A bright, starburst-like light emanates from the point of contact between the welding torch and the metal. The background is dark and out of focus.

STRATEGY
KIM TIN GROUP

■ KIM TIN GROUP 5-Pillar Strategy

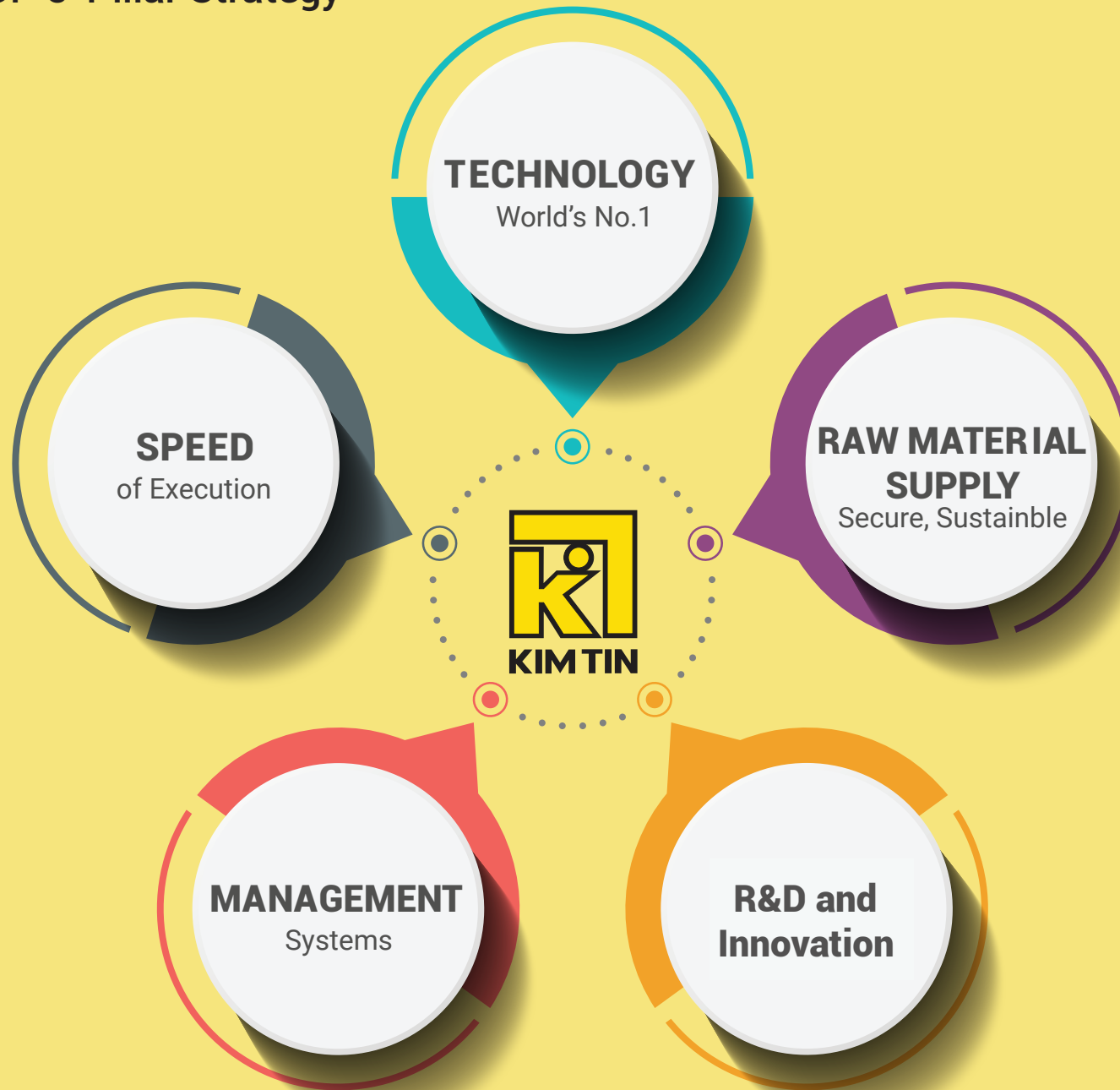

■ Distribution network

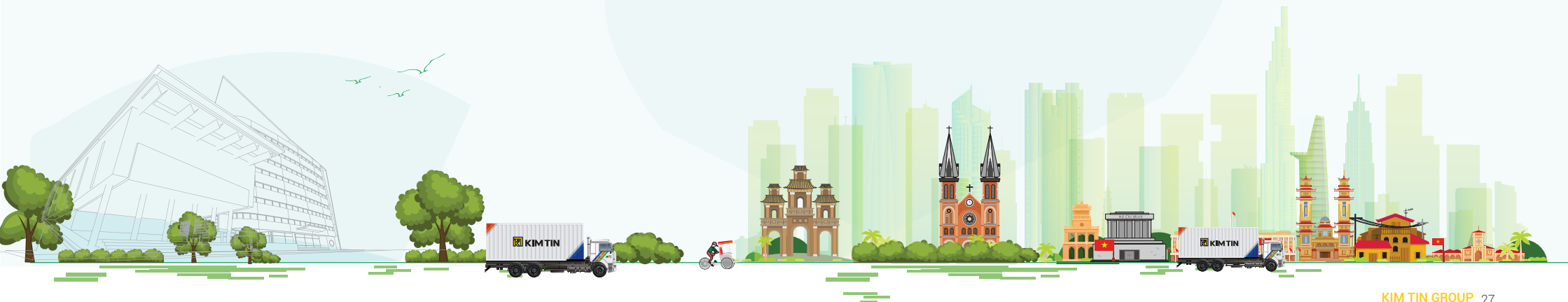
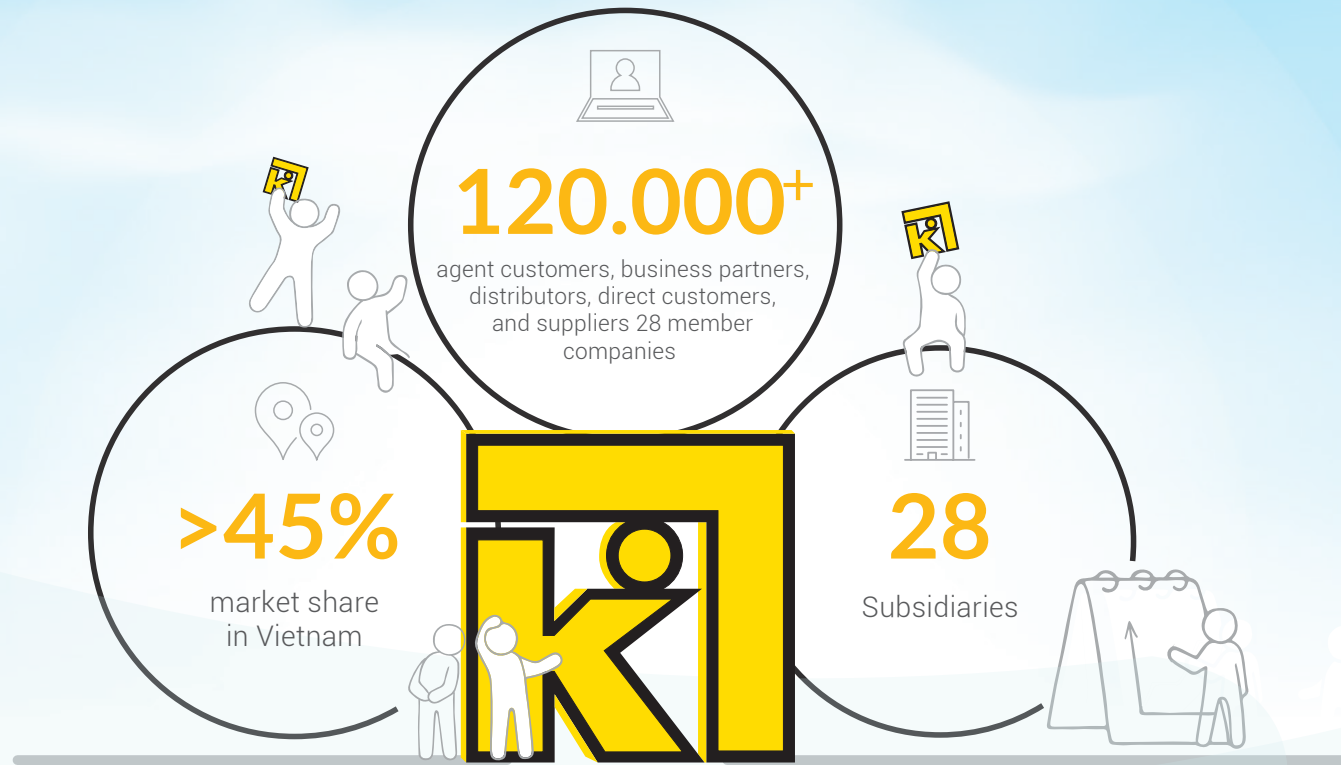

HEAD OFFICE

1 Kim Tin Group Corporation

- 422A - 424 Vo Van Kiet Street, Co Giang Ward, District 1, HCMC

SUBSIDIARIES

2 Kim Tin (Ha Noi) Corporation

- 40 Ngo Gia Tu, Long Bien, Ha Noi

3 Kim Tin Da Nang Corporation

- Street No.6, Hoa Khanh industrial park, Lien Chieu District, Da Nang

4 nPL Logistics Corporation

- 10-12 Street No 9, Tan Tao Industry, Binh Tan

5 Kim Tin Hung Yen Corporation

- D3, D Area, Pho Noi A Industry, Van Lam, Hung Yen

6 Kim Tin Quang Tri Corporation

- Quan Ngang Industry, Gio Linh, Quang Tri

7 Kim Tin Long An Corporation

- Kien Thanh, Long Cang, Can Duoc, Long An

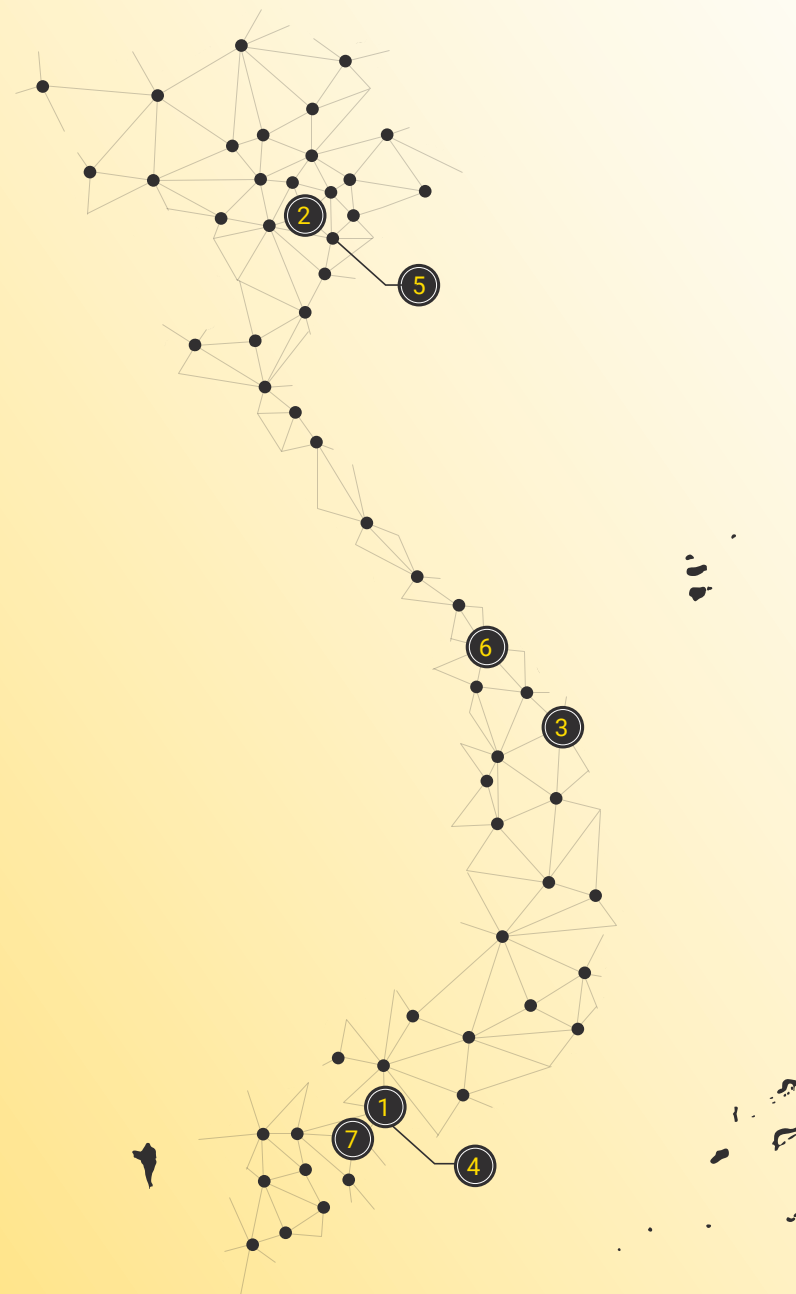

KIM TIN GROUP CORPORATION

🏠 422A - 424 Vo Van Kiet Street,
Co Giang Ward, District 1, HCMC

☎ | (+84.28) 3950 6618

📠 | (+84.28) 3950 6617

🌐 | www.kimtingroup.com

